

**PRODUCT CODE :**

**DESCRIPTION :** 3,7 V 100 mAh –LiPO cell



### GENERAL INFORMATION

This Li-Po cells offer the best energy density of the market for small applications, building portable power solutions needing high energy density and low weight.

### ADVANTAGES

- High energy density.
- Friendly environmental batteries.
- Low cost, long life with more than 500 charging - discharging cycles.
- Low internal resistance with excellent discharging rate.
- Recharging is allowed even after long storage period.
- 1-2 hours fast charge is allowed.
- Wide working temperature range.
- Includes individual BMS protection system.



### APPLICATIONS

Suitable for Cameras, GPS Receivers, PDA, Clocks, Remote Controls, Safety Devices, High Drain Devices, Cordless Phone Tools, Lighting or other device needing 3.7V power. Building portable power device needing high energy density and low weight.

### TECHNICAL CHARACTERISTICS

#### NOMINAL SPECIFICATION

|                                      |   |
|--------------------------------------|---|
| <b>SIZE</b>                          | Pouch Type Cell   |
| <b>NOMINAL CAPACITY (mAh)</b>        | 100 mAh   |
| <b>RATED VOLTAGE (V)</b>             | 3,7 V   |
| <b>IMPEDANCE STANDARD (mΩ)</b>       | ≤450 mΩ   |
| <b>DISCHARGE CUT-OFF VOLTAGE (V)</b> | 3.0 V   |
| <b>DIMENSIONS (L×W×H)</b>            | 25x17x4 (mm)  |
| <b>WEIGHT (gr)</b>                   | 5 gr.   |
| <b>OUTPUT AND INPUT</b>              | P+(red) / P-(black)   |
| <b>AMBIENT TEMPERATURE</b>           | CHARGE → standard = 0°C ~ 45°C<br>DISCHARGE → -10°C ~ 45°C<br>STORAGE → <1 year = -20°C ~ 25°C / <3 months = -20°C ~ 40°C |

PRODUCT CODE :

DESCRIPTION : 3,7 V 100 mAh –LiPO cell

**DRAWING CHARACTERISTICS**

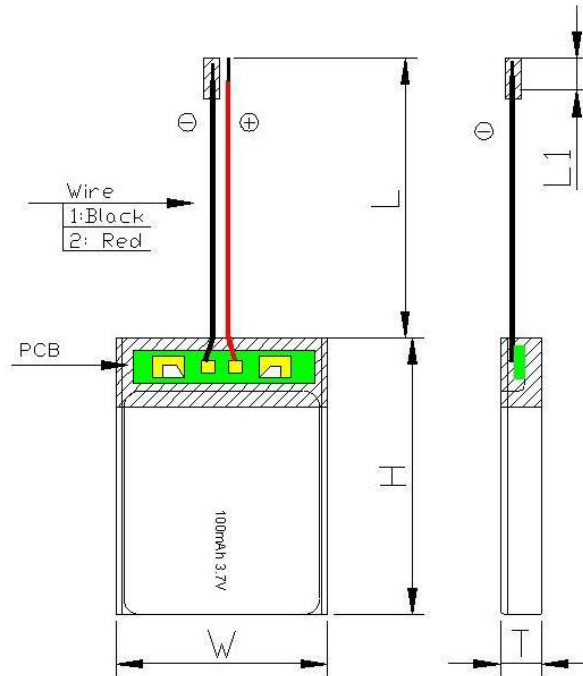

**BMS SCHEMATIC – BMS PCB**

